



## Main Features:-

- ◆ Needle Valve
- ◆ Stem Packing PTFE + Graphite
- ◆ Threaded ends Female ISO 228/1. (BSP)
- ◆ 1/4"-1/2" = 3000 PSI / 260 °C.
- ◆ 3/4"-1" = 3000 PSI / 240 °C

\*Temperature and pressure determined by valve body, seat etc.

## Suitable Applications & Approvals:



HVAC



OIL



GAS



INDUSTRY



## SERIES: 80234

MANUFACTURER: **GENEBRE**

VALVE MATERIALS

ITEM	SECTION	MATERIAL	ADDITIONAL INFO / OPTIONS
1	Body	ASTM A105	Zinc golden
2	Bonnet	ASTM A105	Zinc golden
3	Nut	ASTM A105	Zinc golden
4	Needle	SS A182 F6	Nitrogen Treatment
5	Stem	SS A182 F6	n/a
6	Stem Packing	PTFE + Graphite	n/a
7	Packing Nut	ASTM A105	Zinc golden
8	Handwheel	Cast Iron	Painted
9	Nut	Carbon Steel	Zinc
10	Washer	Carbon Steel	Zinc

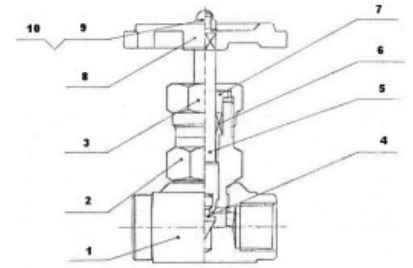

REF	SIZE	PN	E	H	L	K	V	Kg
80234-02	1/4"	3000	25	85	50	3	63	0.26
80234-03	3/8"	3000	30	100	55	4	63	0.36
80234-04	1/2"	3000	34	115	60	6	72	0.53
80234-05	3/4"	3000	40	120	70	8	72	0.76
80234-06	1"	3000	45	138	75	9	80	1.175

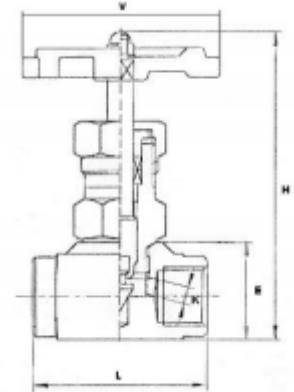

**T** +44 (0)1386 552369

**E** sales@allvalves.co.uk

**W** www.allvalves.co.uk

**F** +44 (0)1386 554227



Genebre are a global brand of industrial valves with large stocks held for fast delivery on various type of valves, sizes, end connections and materials.

**SERIES: 80234**

TORQUE / Kv VALUES / DIMENSIONS

REF	SIZE	Kv
80234-02	1/4"	0.25
80234-03	3/8"	0.36
80234-04	1/2"	0.47
80234-05	3/4"	0.95
80234-06	1"	1.1

### KV VALUES:

- The Kv values (M3 per hour) is the flow of water at a temperature of 5C to 30C (41F to 86F) at p of 1 bar

- For further information, please email [sales@allvalves.co.uk](mailto:sales@allvalves.co.uk)

### PRESSURE TEMPERATURE RATING

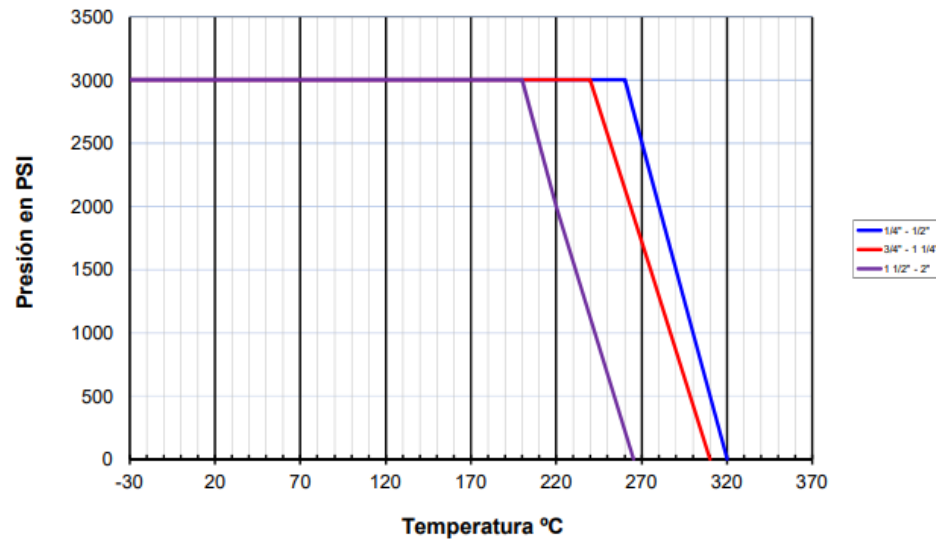

### KV VALUES:

Genebre is a leading company and world reference in fluid control and high-quality taps. They control all the creation processes, responding to the specific needs of each market: from the initial concept and design of the product to the production and commercialization.

### ALL VALVES

Offering a full range of actuated valve packages, manual valve range, pipe fittings and pumps, we have a product for all your requirements. As an ISO 9001-2015 Quality Approved and certified company, All Valves offer a quality service from pre-sale to post sale. Shipping millions of pounds in value of manual valve and actuated valve packages all over the world since its formation, All Valves are a trusted valve and actuator supplier to many companies all over the world. Working with the leading brands in most industries.



T +44 (0)1386 552369

E [sales@allvalves.co.uk](mailto:sales@allvalves.co.uk)

W [www.allvalves.co.uk](http://www.allvalves.co.uk)

F +44 (0)1386 554227